

Sez. A-A

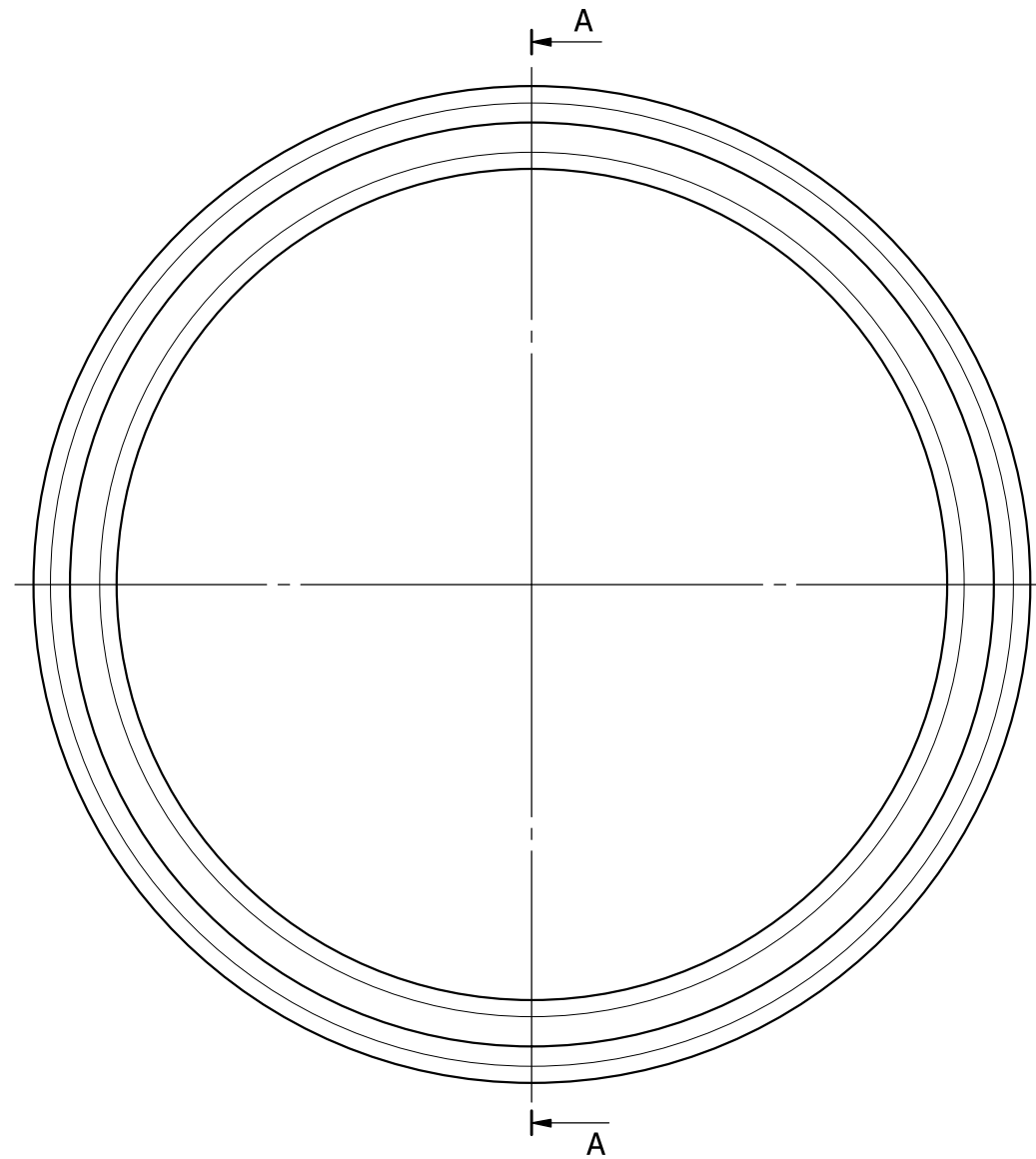

SINGLE PLY FORMED BELLOW
 MATERIAL: AISI 316L
 ID=165 mm
 OD=198 mm
 THICKNESS= 0.3 mm
 FREE LENGTH: 44.8 mm (Note 2)
 NUMBER OF CONVOLUTIONS: 3 (Note 2)
 PITCH: 12.7 mm
 AXIAL STROKE: -10 mm / +10 mm (Note 1)
 INTERNAL PRESSURE: 0 bar
 EXTERNAL PRESSURE: 1 bar
 He LEAK TIGHTNESS < 1x1E-10 Pa m3/s
 AXIAL SPRING RATE: 55.8 N/mm
 N/mm
 WORKING TEMPERATURE: ROOM TEMPERATURE
 N. CYLES: 1000 MIN
 MAGNETIC PERMEABILITY $\mu_r \leq 1.05$
 SURFACE FINISH: 2R (EN 10088-2)

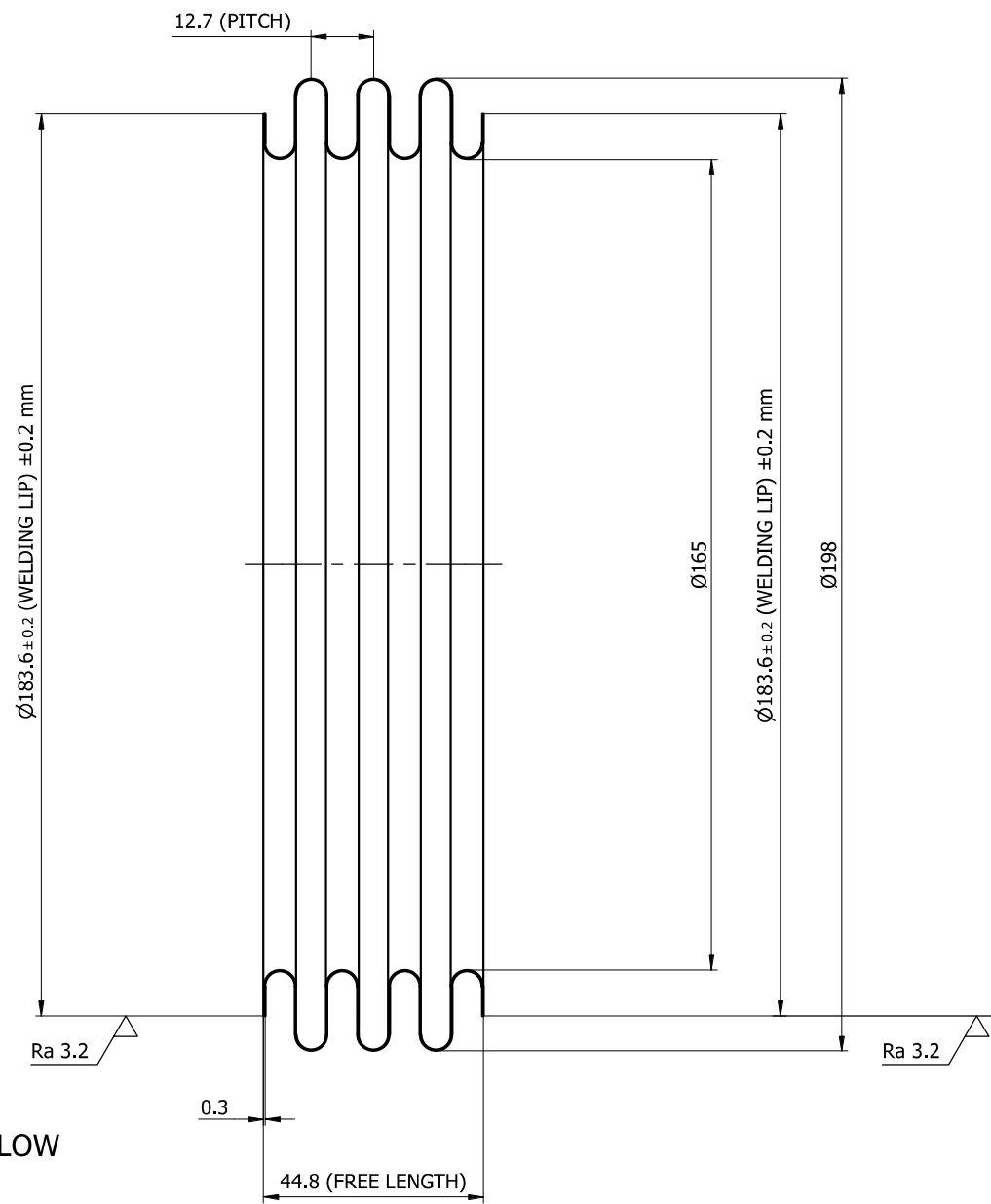
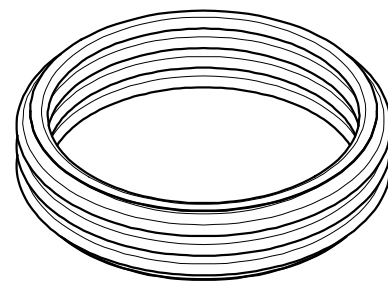

NOTES:

- IF THE BELLOW IS PRODUCED WITH ADDITIONAL CONVOLUTIONS, THE TOTAL STROKE (± 10 mm) MUST BE WARRANTIED BY THE REMAINING CONVOLUTIONS (AFTER THE MACHINING OF THE WELDING LIPS)
- VALUE AFTER MACHINING

FOLLOWING DOCUMENTS ARE REQUIRED:

- MATERIAL CERTIFICATE 3.1B EN 10204
- TECHNICAL REPORT WITH CALCULATION CODE USED

APPLICARE LE PROCEDURE:	SLT-1
	DCC-2
	CLN-2
	VLC-2
APPLICABLE PROCEDURES:	

AISI 316L	0,19 kg
MATERIALE Material	MASSA [kg] Mass [kg]

TOLLERANZE GENERALI	< 6	6-30	30-120	120-400	400-1000	>1000	< 10	10-50	50-120	120-400	> 400
General tolerances	UNI EN ISO 22768 - fH <input type="checkbox"/>	± 0.05	± 0.1	± 0.15	± 0.2	± 0.3	$\pm 1^\circ$	$\pm 0^\circ 30'$	$\pm 0^\circ 20'$	$\pm 0^\circ 10'$	$\pm 0^\circ 5'$
	UNI EN ISO 22768 - mK <input checked="" type="checkbox"/>	± 0.1	± 0.2	± 0.3	± 0.5	± 0.8					

	A TERMINI DI LEGGE CI RISERVIAMO LA PROPRIETA' DI QUESTO DISEGNO CON DIVIETO DI RIPRODURLO O DI RENDERLO COMUNQUE NOTO A TERZI SENZA LA NOSTRA AUTORIZZAZIONE AS BY LAW ENACTED WE RESERVE THE RIGHT OF OWNERSHIP OF DRAWING. THE DOCUMENT AND INFORMATIONS CONTAINED HEREIN MAY NOT BY COPYED USED OR DISCLOSED WITHOUT OUR PERMISSION	SPIGOLI NON QUOTATI ISO 13715 Edges of undefined shape ISO 13715	-0.2 +0.2	
	SIMBOLI DI RUGOSITA' ISO 1302 Symbols for roughness ISO 1302	DISEGNATO Draw	MARCO CANETTI	08/11/2023
	SCALA Scale	VERIFICATO Controlled	DANIELE EBRI	08/11/2023
FORMATO Size	A3	APPROVATO Released	CARLO BELLIERO	08/11/2023

DESCRIZIONE Description	SPECIAL BELLOW DN 150	23130-3-23	REVISIONE Revision
----------------------------	-----------------------	------------	-----------------------